

The suction units of the PD series with power from 1.1 to 15 kW are used in pneumatic conveying systems for throughputs of up to 3000 kg/h over distances of up to 150m.



TECHNICAL SPECIFICATIONS:

- 1- to 3-stage side-channel blowers.
- Self-cleaning filters with polyester cartridges and dust container.
- RS485 ModBus interface.

ACCESSORIES:

- Pressure gauge for clogged filter alarm.

ADDED VALUE:

- VERSATILE
- Suction units are available with two loading stations.

Suction units

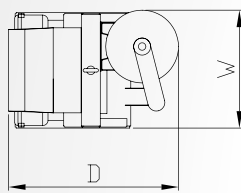
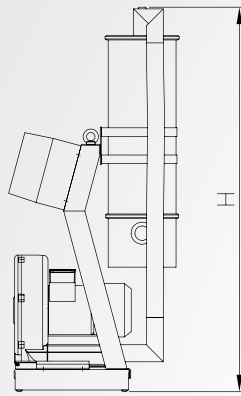

PD1-3 (FC1)

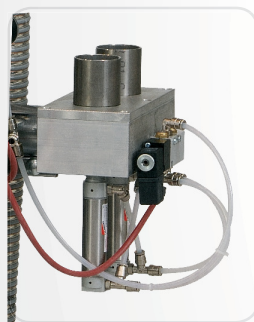

Duo-System valve

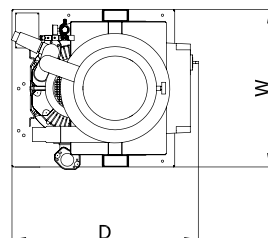
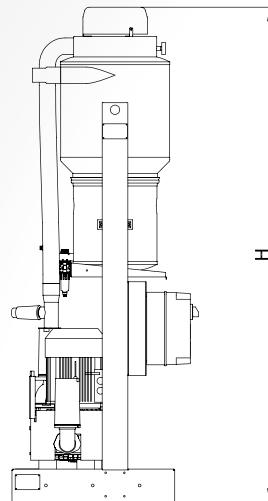

PD3-PD11 (FC3)

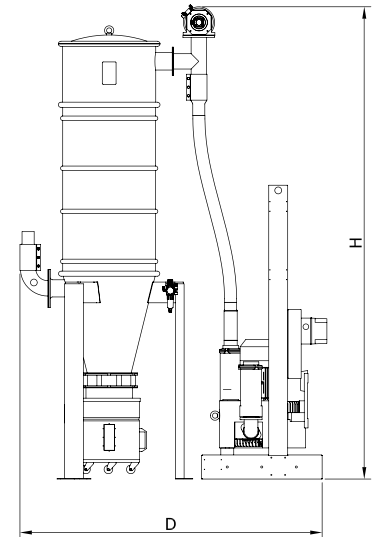
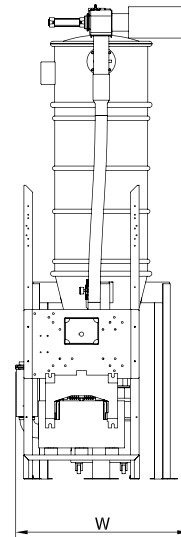

PD7-15 (FC8)

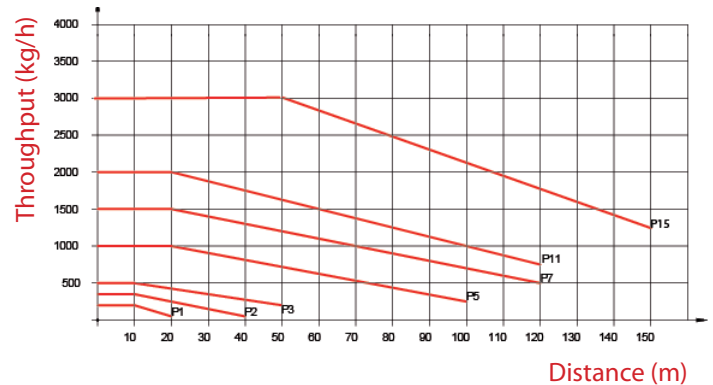

TECHNICAL DATA		PD1	PD2	PD3	PD5	PD7	PD11	PD15
Suction capacity	kg/h	200	300	500	1000	1500	2000	3000
Power 400V/50Hz	kW	1.1	1.5	3	5.5	7.5	11	15
Power 460V/60Hz	kW	1.3	1.7	3.4	6.3	9	12.6	17.3
Vacuum	kPa	16	20	26	43	43	43	60
Noise level	dB(A)	61	61	70	75	75	75	75
Vacuum line	Ø mm	40	40	50	50/60	60/70	60/70	70/89
Filter (optional) Filtering surface	model m ²	FC1/FZ1 2.9/1.8	FC1/FZ1 2.9/1.8	FC1/FC3 2.9/11	FC3 11	FC3/FC8 11/13	FC3/FC8 11/13	FC8 13
Type of filter cleaning		Self-cleaning						
Compressed-air pressure	bar	6-8	6-8	6-8	6-8	6-8	6-8	6-8
Compressed-air consumption	l/s	0.5	0.5	0.5	0.5	0.5	0.5/1.5	0.5/1.5
Dimensions WxDxH	Filter FC1	381x540x1137	381x540x1137	381x540x1137	-	-	-	-
	Filter FZ1	417x473x770	417x473x770	-	-	-	-	-
	Filter FC3	-	-	673x700x2021	685x796x2114	717x783x2112	717x857x2112	-
	Filter FC8	-	-	-	-	1006x1760x2738	1006x1781x2738	1061x2404x2738
Weight	kg	30	40	60/140	190	210	230	300